



AMBULANCE TYPE:

Crestline

UNITS AFFECTED:

62900 – 92910 / 62990 - 62999

**ISSUE:** Suction unit upgrade to disposable canisters.

**ACTION:** Replace existing suction unit with supplied upgrade unit.

Labour time: .3 hr Please use labour code **GMOSU** on invoice.

**SERVICE PROCEDURE:**

- 1) Remove existing suction unit and discard.

Remove the suction hose from the wall fitting.



Remove the canister by unscrewing the thumb screw.



Remove 90° fitting.

Remove the 4 screws.



AMBULANCE TYPE:

Crestline

UNITS AFFECTED:

62900 – 92910 / 62990 - 62999

## 2) Install new suction unit.

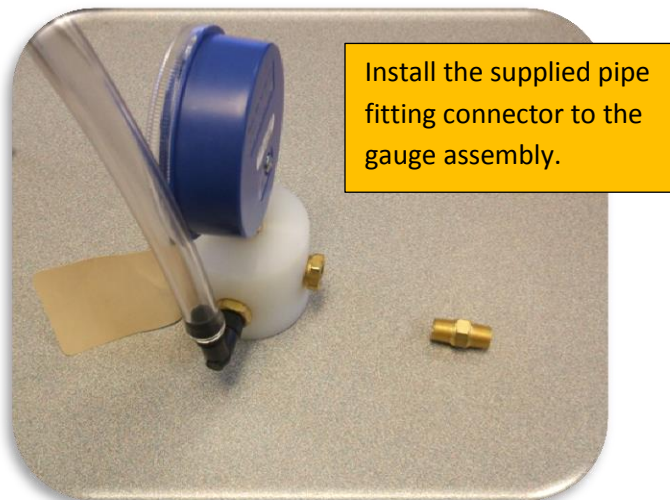

Thread the gauge assembly into the wall socket.

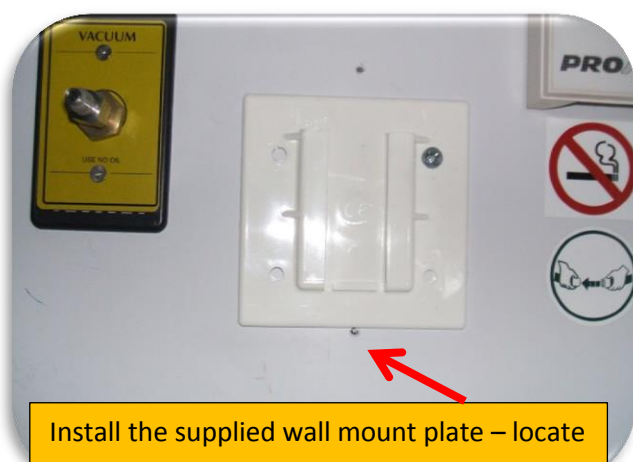
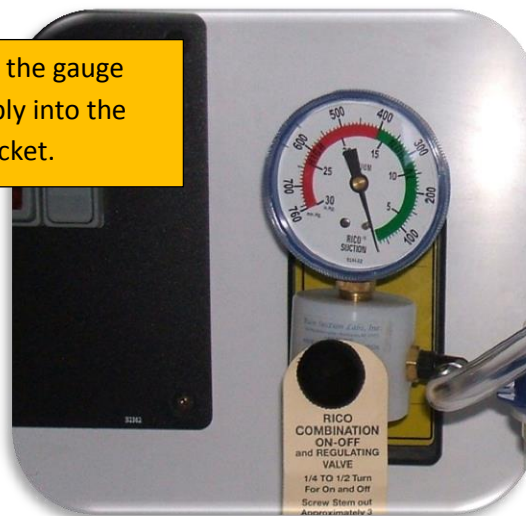

Install the supplied wall mount plate – locate the plate just above the bottom hole – use the wall mount plate as template to drill the screw holes – install the supplied screws.





AMBULANCE TYPE:

Crestline

UNITS AFFECTED:

62900 – 92910 / 62990 - 62999

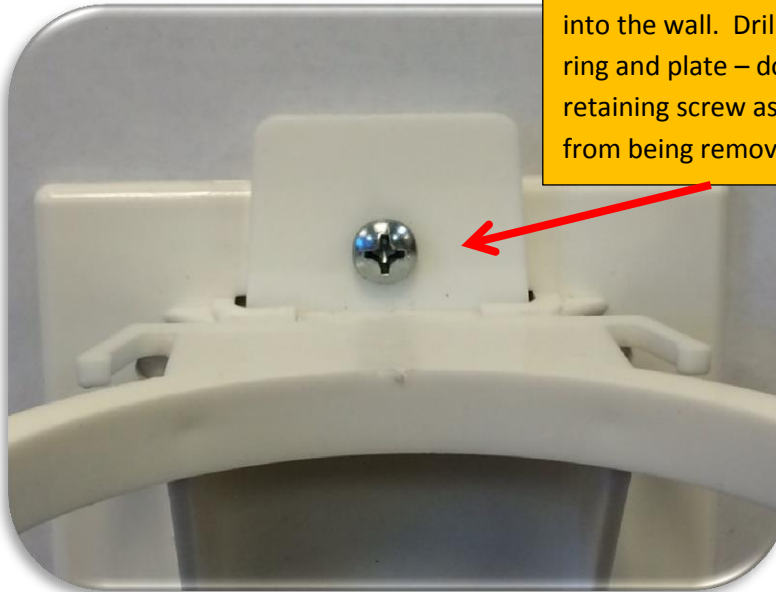

Drill a 1/8" pilot hole through the mount ring and into the wall. Drill a 7/32" hole through the mount ring and plate – do not drill into the wall. Install the retaining screw as shown. This will prevent the ring from being removed with the canister.

Install the new canister into the mounting ring.



Connect all vacuum hoses.

